

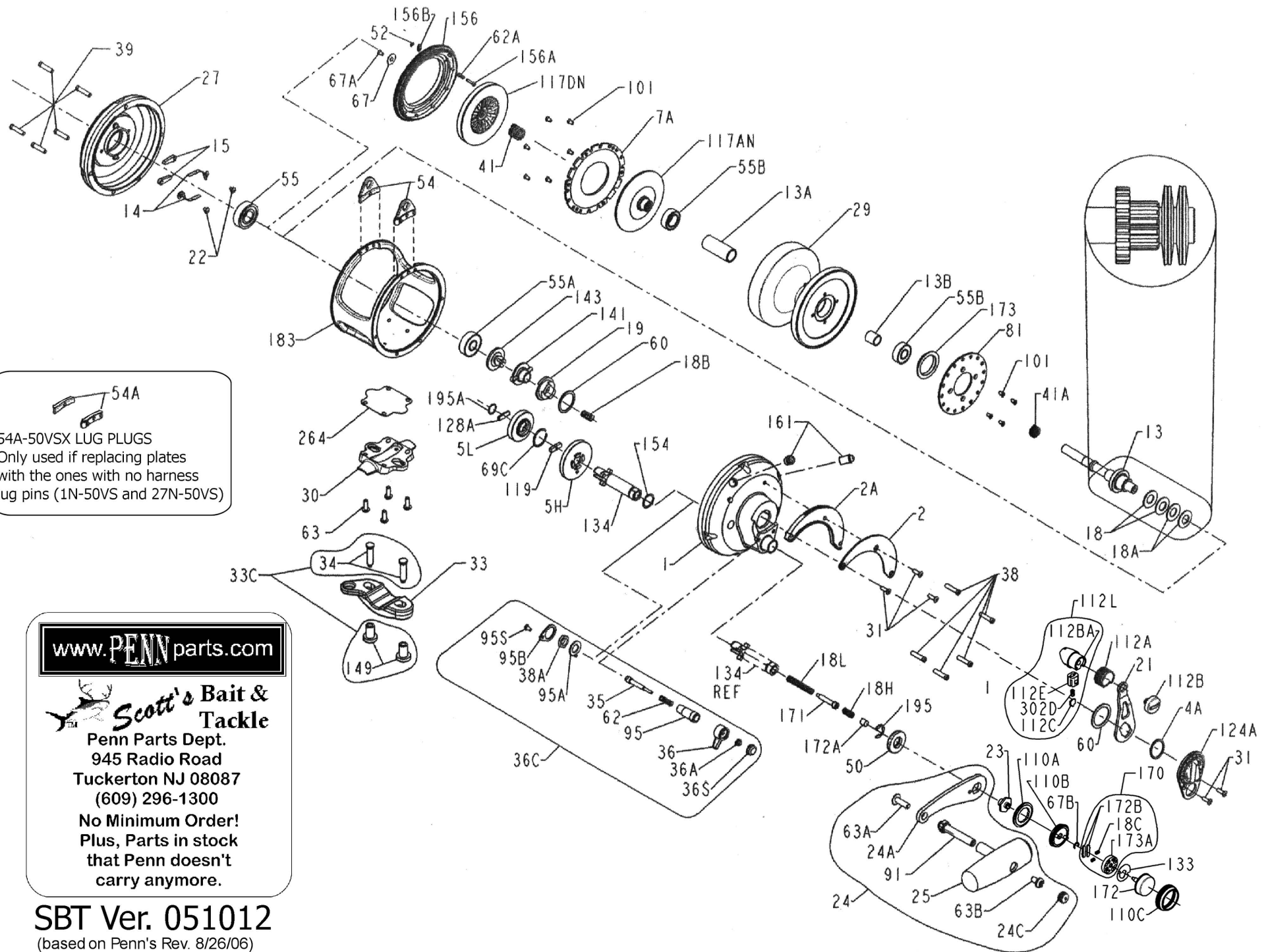

# PARTS LIST FOR MODEL 50VSX



**54A-50VSX LUG PLUGS**  
Only used if replacing plates with the ones with no harness lug pins (1N-50VS and 27N-50VS)

[www.PENNparts.com](http://www.PENNparts.com)

**Scott's Bait & Tackle**  
Penn Parts Dept.  
945 Radio Road  
Tuckerton NJ 08087  
(609) 296-1300  
No Minimum Order!  
Plus, Parts in stock that Penn doesn't carry anymore.

**SBT Ver. 051012**  
(based on Penn's Rev. 8/26/06)

## Penn Reel Parts list for:

KEY	PART	DESCRIPTION
1	***	SEE NOTES BELOW
2	2-50VS	QUADRANT RING
2A	2A-50VS	QUADRANT RATCHET/SPACER
4A	4-12LT	TEFLON THRUST WASHER
5H	5N-50VS-HS	MAIN GEAR HIGH-SPEED
5L	5N-50VS-LS	MAIN GEAR LOW-SPEED
7A	7A-50VS	METAL DRAG WASHER
13	13-50VSX	PINION GEAR
13A	13B-50VSX	SPOOL SLEEVE
13B	13B-70	PINION GEAR SLEEVE
14	14-50	DOG SPRING (2 REQ.)
15	15-50	DOG (2 REQ.)
18	18-50TW	DISC CLUTCH SPRING (2 REQ.)
18A	18-50W	DISC CLUTCH SPRING (2 REQ.)
18B	18-349	SPRING
18C	18C-15KG	SHIFT BUTTON SPRING (2 REQ.)
18H	18H-30VS	SHIFT SPRING (HEAVY)
18L	18L-30VS	SHIFT SPRING (LIGHT)
19	19-50VS	ECCENTRIC CAM
21	21-50VS	ECCENTRIC LEVER
22	22-109	DOG SPRING SCREW
23	23-30VS	HANDLE SCREW (2 REQ.)
24	24-30VS	HANDLE COMPLETE
24A	24-30VS-1	HANDLE METAL BLANK ONLY (NO KNOB)
24C	24C-50M	HANDLE KNOB CAP
25	25-50M	HANDLE KNOB
27	***	SEE NOTES BELOW
29L	29N-50VSX	SPOOL
30	30-50VS	STAND
31	31T-70	SHORT SCREW (5 REQ.)
33	33-70	ROD CLAMP
33C	33C-70VS	ROD CLAMP KIT W/ALL STUDS/NUTS
34	34-70VS	CLAMP SCREW (2 REQ.)
34C	34C-70VS	ROD CLAMP SCREW W/NUT
35	35-70	CLICK TONGUE
36	36N-50	CLICK BUTTON
36C	36C-50VSW	CLICKER ASSEMBLY
36A	36-700	CLICK BUTTON NUT
36S	36S-80ST	CLICK BUTTON CAP
38	38-50VSX	RIGHT SIDE PLATE SCREW (5 REQ.)
38A	38-710	CLICK BUSHING NUT
39	39-50VSX	LEFT SIDE PLATE SCREW (5 REQ.)

## Model: 50VSX International V Series

KEY	PART	DESCRIPTION
63	63-30T	STAND SCREWS (4 REQ.)
63A	63A-50	HANDLE RIVET SCREW
63B	63-50	HANDLE KNOB SCREW
67	67-70	PINION RETAINING WASHER
67A	67A-70	PINION RETAINING SCREW
67B	67-30VS	SHIFTER RETAINING RING
69C	69C-245	H/L GEAR RETAINING RING
81	81-50	RATCHET DISC PLATE
91	91N-50	HANDLE RIVET
95	95-70	CLICK TONGUE BUSHING
95A	95A-50	CLICK BUSHING WASHER
95B	95B-70	CLICK RETAINING PLATE
95S	46A-704	CLICK RETAINING PLATE SCREW
101	101-30	RATCHET PLATE SCREW (10 REQ.)
110A	110A-30VS	HANDLE LOCKING PLATE
110B	110B-30VS	SHIFT HOUSING
110C	110C-30VS	SHIFTER BUTTON RETAINING RING
112L	112-30VS	DRAG LEVER KNOB ASSEMBLY
112	112B-30VS	DRAG LEVER KNOB
112A	112A-30VS	KNOB SLEEVE
112B	112B-70	DRAG KNOB SCREW
112C	112C-30VS	DRAG CLICK PLATE
112E	112E-30VS	DRAG LEVER CLICK PLATE HOUSING
117A	117AN-70	INNER DRIVE PLATE ASSEMBLY
117D	117DN-70VS	DRIVE PLATE ASSEMBLY
119	119-24KG	COUPLING PLATE
124A	124L-50VS	BRIDGE COVER ASSEMBLY
*128	128-50S	LOW GEAR PINS (6 REQ.)
128A	128A-24KG	LOW GEAR DRIVE PLATE
133	133-30VS	SHIFTER RETAINING PLATE
134	134N-50VS	GEAR STUD
141	141-50VS	CAM FOLLOWER
143	143-50VS	PRESET SCREW
149	149-70	ROD CLAMP NUT (2 REQ.)
154	154-80	GEAR STUD SHIM
156	156N-50VS	DRAG COVER
156A	156A-30VS	LOCK PIN
156B	156B-30VS	LOCK PLATE
161	161C-70	DRAG LOCATING PIN ASSEMBLY (2 REQ.)
*162	162-50	LOCATING PIN SPRING (2 REQ.)
170	170-30VS	SHIFTER CATCH HOLDER ASSEMBLY
171	171-30VS	SHIFT PLUNGER (SCREW)

41	41-50	BEARING SPRING	172	172-30VS	SHIFT BUTTON (LOW)
41A	41-70	DRAG SPRING	172A	172A-50VS	SHIFTER SPACER
50	50-50VS	GEAR STUD SHIELD	172B	173-30VS	SHIFTER CATCH PLATE (2 REQ.)
52	52-910	RETAINING RING	173	173-50VS	SPOOL BUSHING
54	***	SEE NOTES BELOW	173A	173A-30VS	SHIFTER CATCH HOLDER
*54A	***	SEE NOTES BELOW	183	183N-50VS	TUBE FRAME W/ DOWL PINS
55	55-80	BALL BEARING	195	195-40	RETAINING RING
55A	55-50	BALL BEARING	195A	195-24KG	SPIRAL RETAINING RING
55B	55-80ST	BALL BEARING (2 REQ.)	264	264-30VS	STAND GASKET
60	60-50	DRAG THRUST WASHER (OLD #4-70)	302D	302D-525MAG	DRAG CLICK PLATE SPRING
62	62-50	CLICK SPRING			
62A	62-545	DRAG COVER LOCK SPRING			

NOTE: Many of www.pennparts.com schematics include changes that were either made by Penn, or errors found and corrected by our parts dept.  
SBT Ver. 051012 (based on Penn's Rev. #8-29-06)

### **NO HARNESS LUGS**

1	1N-50VS	RIGHT SIDE PLATE ASSEMBLY
27	27N-50VS	LEFT SIDE PLATE ASSEMBLY
54A	54A-50VSX	HARNESS LUG PLUG (2 REQ.)

### **WITH HARNESS LUGS**

1	1N-50VSX	R.S. PLATE ASSEMBLY WITH LUG PINS
27	27N-50VSX	L.S. PLATE ASSEMBLY WITH LUG PINS
54	54-50VSX	HARNESS LUG (2 REQ.)

NOTE: 161C WAS ORIGINALLY 161C-30VS THEN CHANGED TO 161C-70